

## SPARE PARTS

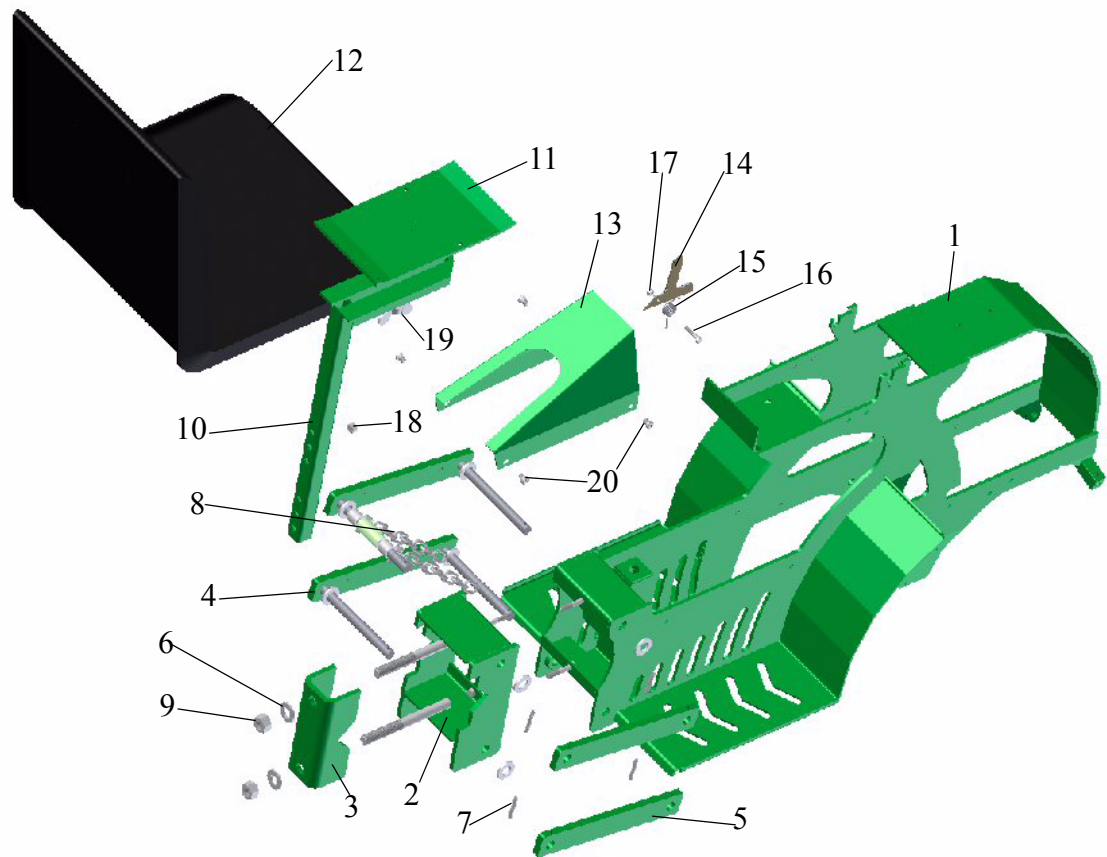

1. Body of planting unit	1	6451020		
2. Body fastener	1	6451030		
3. Attaching part	1	6446259		
4. Parallel linkage	2	6446276		
5. Parallel arm, removable	2	6429240		
6. Washer	10	2451145	Ø 16	
7. Spring bolt pin	4	2477366	6x40	DIN 1481
8. Support chain	2	6430940		
9. Hexagonal nut	2		M16	
10. Seat attaching part	1	6427720		
11. Seat attaching plate	1	6427700		
12. Seat	1	6427740	Pocca	
13. Cover	1	6429640		
14. Regulating catch	1	6429920		
15. Spring	1	6430980		
16. Hexagonal screw	1		M6x30	
17. Hexagonal nut	1		M6	
18. Hexagonal nut	2		M8	
19. Hexagonal nut	1	2430771	M12	
20. Slot-headed screw	4		M8x10	

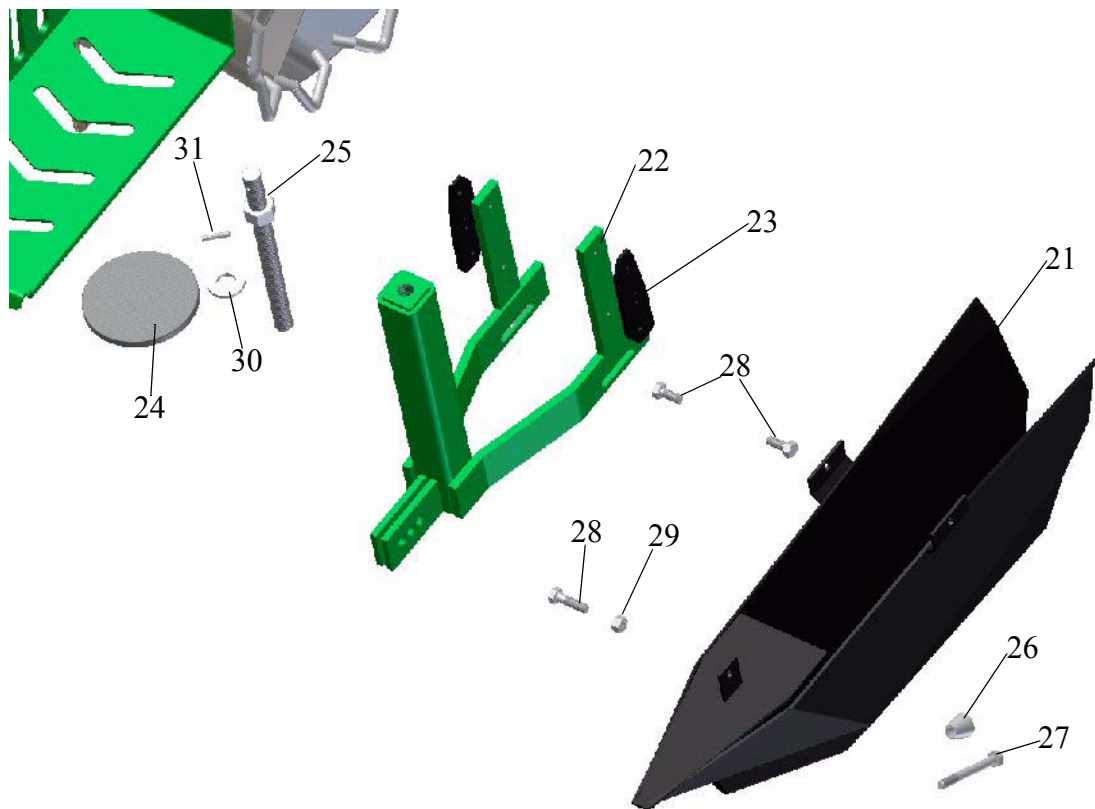

21. Ploughshare	1	6439420	long, m. tobacco
		6427430	standard
		6426800	wide
		6426530	long, stainless
22. Ploughshare arm	1	6451034	
23. Glide	2	6427510	
24. Regulating wheel	1	6429580	
25. Adjusting screw	1	6429570	
26. Trimming piece	1	6427660	standard
		6426820	big
27. Hexagonal screw		2353162	M10x80
28. Hexagonal screw	3		M8x25
29. Hexagonal nut	1		M8
30. Washer	1	2451145	Ø 16
31. Spring bolt pin	1	6900630	Ø 5x25

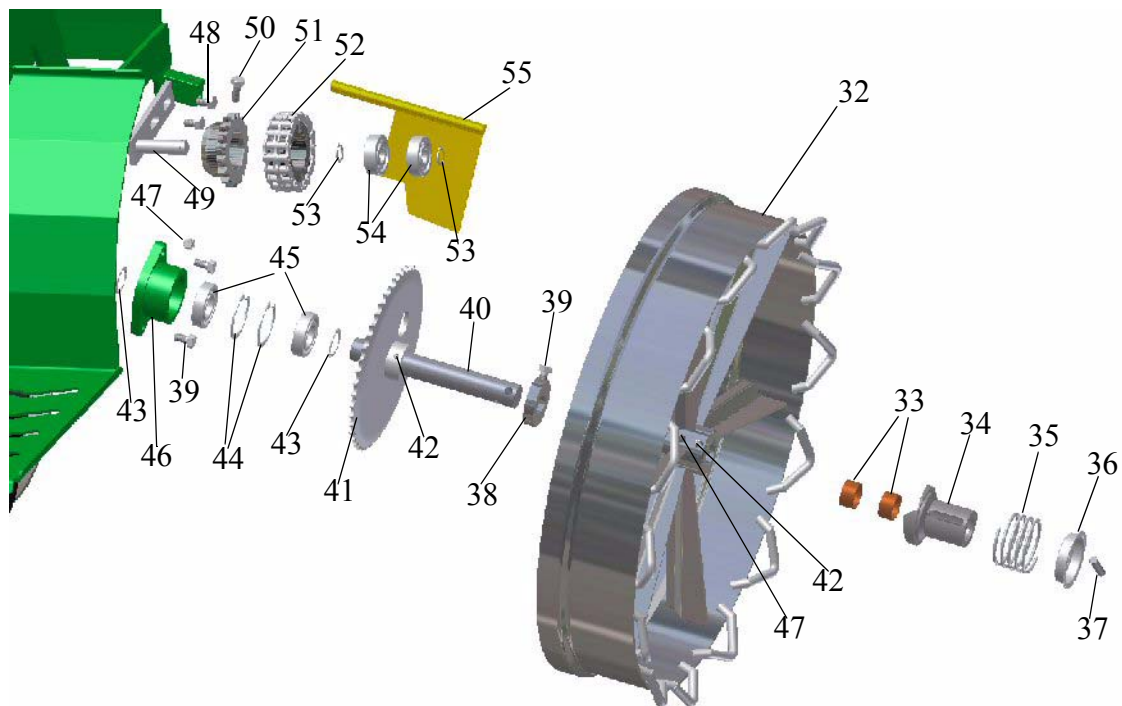

32. Packing wheel, big, with cleats	2	6430562	assembled 6452370
Packing wheel, standard		6430560	assembled 6452360
33. Slide sleeve	4	6940320	Drymet 701-2515
34. Overrunning clutch, right	1	6435900	
Overrunning clutch, left	1	6435901	
35. Spring	2	6430740	
36. Spring locking plate	2	6427060	
37. Locking pin	2	6430890	
38. Locking ring	2	6430750	
39. Hexagonal screw	2	2352058	DIN 933 M8x20
40. Wheel shaft	2	6428400	
41. Sprocket	2	6430640	
42. Spring bolt pin	6	2477230	Ø 5x40
43. Arresting ring	4	2595655	DIN 471 Ø 25x1.2
44. Arresting ring	4	2595216	DIN 472 Ø 47x1.75
45. Slot ball bearing	4	6906730	6005 RS
46. Bearing housing	2	6430760	
47. Grease nipple	4	2906790	DIN 71412 AM10x1
48. Hexagonal screw	4		M8x16
49. Driven wheel shaft	2	6428370	
50. Hexagonal screw	2		
51. Sprocket	2	6428380	
52. Double chain	2	6428390	
Chain shackle	2	6906920	
53. Arresting ring	4	6905240	DIN 471 Ø 15x1
54. Slot ball bearing	4	2570820	6302 2RS
55. Scraper, wide	2	6430450	
Scraper, standard		6430970	

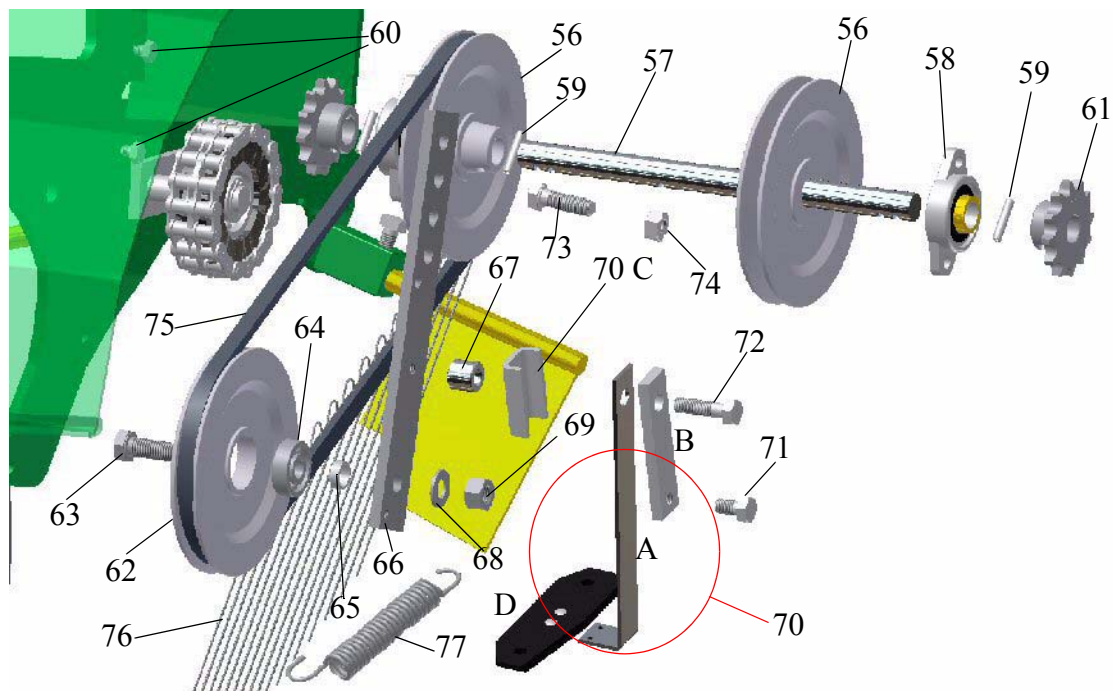

56. Upper cone belt pulley	2	6430630	
57. Shaft	1	6430660	
58. Flange-mounted bearing	2	6900700	UFL002 Silver
59. Spring bolt pin	4	6900630	Ø 5x25
60. Hexagonal screw	4		M6x16
61. Sprocket	2	6430650	
Spike presser assembly	2	6452290	
62. Driven wheel	2	6429930	
63. Hexagonal screw	2		M10x35
64. Slot ball bearing	2	2571500	6200 2RS
65. Bushing	2	6426850	
66. Belt pulley arm	2	6429770	
67. Bushing	2	6426960	
68. Washer	2		Ø10
69. Hexagonal nut	2		M10
70. Spike presser	2	6429790	
A. Spring		6429800	
B. Support plate		6429810	
C. Intermediate plate		6429820	
D. Glide		6427510	
71. Hexagonal screw	2		M8x16
72. Hexagonal screw	2	2352085	DIN 933 M8x30
73. Hexagonal screw	2		M8x25
74. Hexagonal nut	2		M8
75. Spike belt, right	1	6435930	
Spike belt, left	1	6435931	
76. Spike	40	6435880	
77. Spike belt tightening spring	2	6439450	

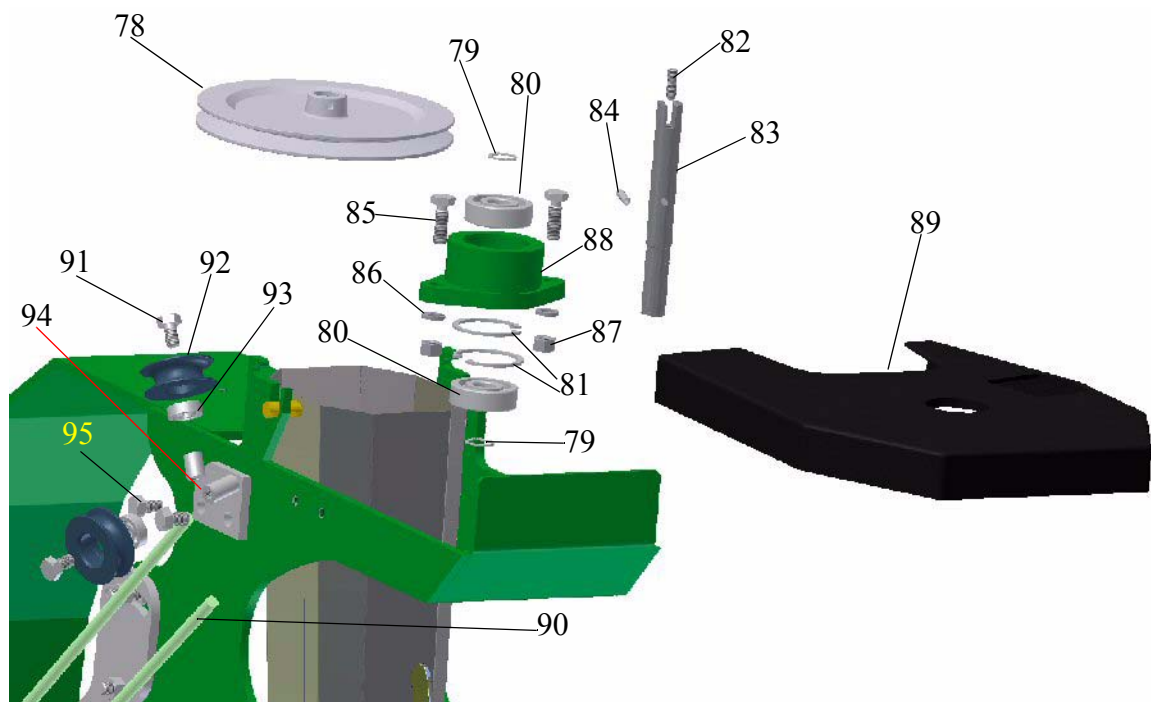

78. Carousel drive wheel	1	6430590	
79. Arresting ring	2	6905240	DIN 471 15x1
80. Slot ball bearing	2	2570820	6302 2RS
81. Arresting ring	2	6906200	DIN 472 42x1.75
82. Hexagonal socket-head screw	1	2416610	M6x25
83. Shaft	1	6429860	
84. Spring bolt pin	1	2477301	DIN 1481 Ø 5x26
85. Hexagonal screw	2	2352076	M8x25
86. Spring washer	2		Ø8
87. Hexagonal nut	2		Nyloc
88. Bearing housing	1	6430600	
89. Pulley covering plate	1	6439410	
90. Carousel driving belt	1	6428590	Ø8 1350 mm
91. Hexagonal screw	2	2352030	M8x16
92. Driven wheel pulley	2	6428420	
93. Slot ball bearing	2	2570075	608 2RS
94. Driven wheel bed	1	6429620	
95. Hexagonal screw	2	2352030	M8x16

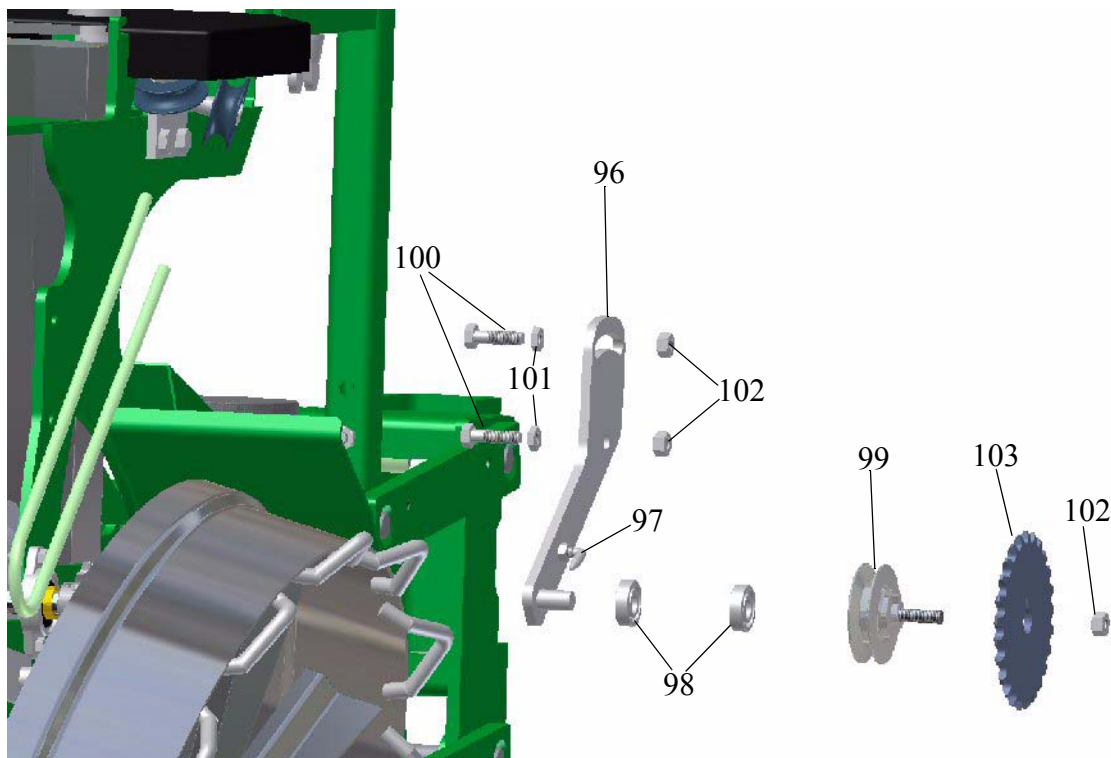

96. Drive wheel arm	1	6429960	
97. Slot cleaner	1	6429990	
98. Slot ball bearing	2	2570310	6001 2RS
99. Drive wheel	1	6430000	
100. Hexagonal screw	2	2352085	M8x30
101. Hexagonal nut, low	2		DIN EN 24035
102. Hexagonal nut	3		M8
103. Plant spacing sprocket, z=No. of teeth			

6427080 z=10	6427130 z=30
6427090 z=11	6427132 z=32
6427100 z=12	6427140 z=35
6427110 z=13	6427137 z=37
6427114 z=14	6427138 z=38
6427115 z=15	6427150 z=40
6427116 z=16	6427142 z=42
6427117 z=17	6427145 z=45
6427118 z=18	6427148 z=48
6427119 z=19	
6427201 z=20	
6427121 z=21	
6427122 z=22	
6427123 z=23	
6427124 z=24	
6427120 z=25	
6427126 z=26	
6427128 z=28	

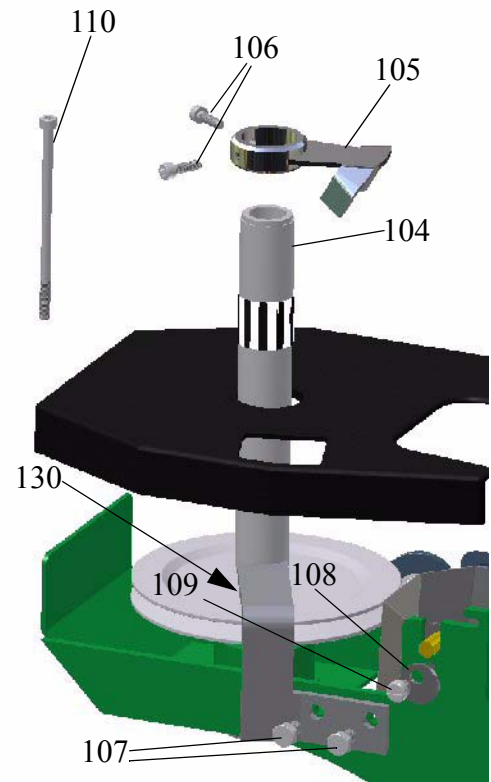
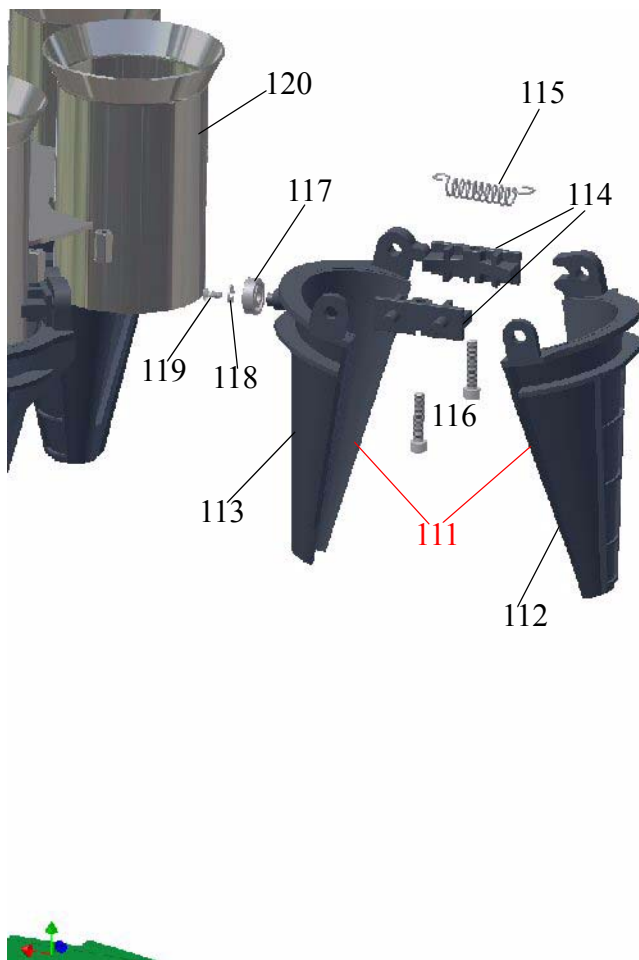

**6-tube carousel with plastic jaws****6439310**

104. Fastener for jaw opener	1	6439600
105. Jaw opener	1	6439400
106. Hexagonal socket-head screw	2	
107. Hexagonal screw	2	2352030
108. Adjustment washer	1	6428410
109. Crosshead screw	1	
110. Hexagonal socket-head screw		
216 mm	1	6439380
111. Pair of plastic jaws	6	6439640
112. Carousel jaw		6439570
113. Carousel jaw		6439560
114. Jaw fastener	12	6439580
115. Spring	6	6439300
116. Hexagonal socket-head screw	12	6909170
117. Slot ball bearing	6	2570075
118. Washer	6	2451299
119. Crosshead screw	6	6909180
120. Carousel body	1	6439730
130. Carousel lock washer	1	

**6-tube carousel****M6x20****DIN 933 M8x16****M8x12****DIN 912 A 12.9 M6x220****DIN 912 M6x25****608 2RS****Ø4****4x10 TR1442****Ø16 DIN 6798**

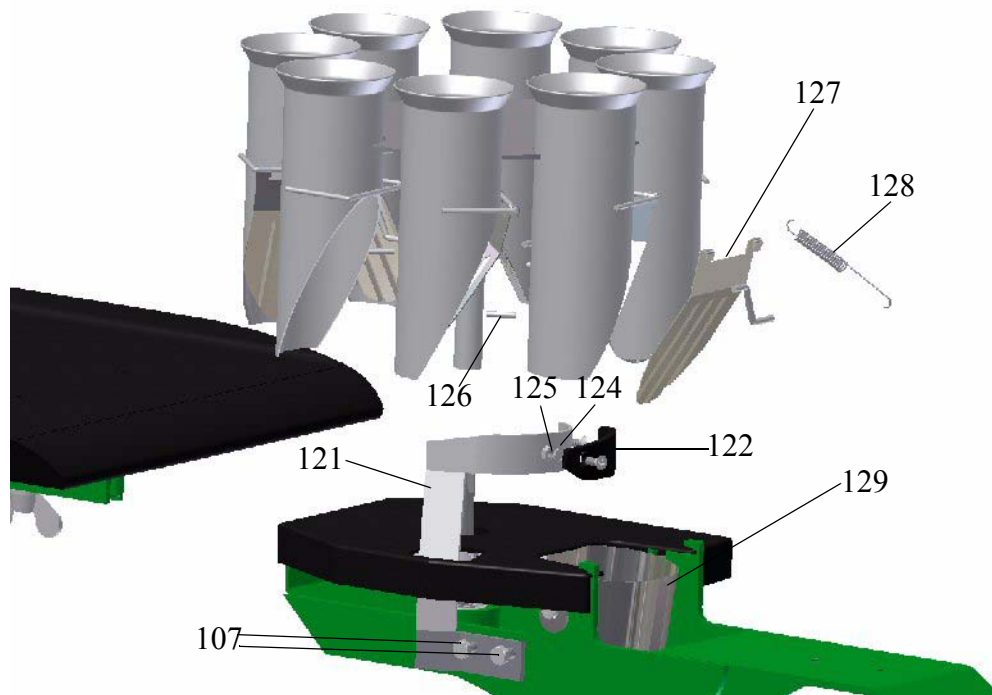

121. Jaw opener	1	6427500	
122. Plastic glide	1	6427510	
123. Countersunk crosshead screw	2	2372410	DIN 963 M6x20
124. Washer	2	2451074	DIN 126 Ø6
125. Hexagonal nut	2	2430744	DIN 934 M6
126. Spring bolt pin	1	2477301	DIN 1481 Ø5x26

### 8-tube carousel, D72 **6427770**

127. Carousel jaw	8	6427843	with slot
128. Carousel spring	8	6428360	

### 10-tube carousel, D61 **6427040**

127. Carousel jaw	10	6427461	
128. Carousel spring	10	6428360	

### 10-tube carousel, D48 **6426100**

127. Carousel jaw	10	6426220	
128. Carousel spring	10	6428360	

129. Chute			
Chute, Ø 60 mm	6429870	standard	
Chute, 108x120 / 70x85	6426520	<b>6429870 now replaced by 6426521</b>	
Chute, Ø 40 mm	6427970		



## DECLARATION OF CONFORMITY

We,

LÄNNEN TEHTAAT OYJ  
Lännen Plant Systems  
P.O. Box 170  
FI-27801 Säkylä  
Finland,

declare under our sole responsibility that the product

**Lännen RT-20 planting machine, serial No.** \_\_\_\_\_

to which this declaration relates is in conformity with the following standards or other normative documents:

- Directive 98/37/EC
- Amendments made to it
- National provisions relating to above (Vnp 1314/94 in Finland).

Säkylä, March 1, 2004

Hannu Vahanen  
Production Manager

## GUARANTEE

concerning Lännen Tehtaat Oyj's planting equipment

1. The guarantee period is twelve months from the date the product was delivered to the customer, however, maximum eighteen months from the date the product was shipped from the factory, unless this period is separately limited. Liability for repairs made during the guarantee period ceases at the same time as the guarantee expires.
2. The guarantee concerns defects in materials or in workmanship that have been detected and notified of to the supplier during the guarantee period. The supplier shall compensate for the defective part by supplying a corresponding new part or by repairing the defective part.

At the supplier's discretion, the labour costs relating to the defective part to be covered by the guarantee and caused during normal working hours can also be compensated for.

The guarantee does not concern any work performed by others than the supplier or a person authorized by the supplier.

3. The guarantee does not cover:
  - wearing materials
  - indirect costs caused by the defect or deficiency
  - freight costs
  - travelling expenses or costs relating to overtime work
4. The guarantee does not concern damages due to
  - faulty use
  - natural wear and tear
  - alterations or additions not approved by the supplier
  - faulty repair or faulty spare part.
5. If there is a defect to be covered by the guarantee, the supplier must be notified immediately. The supplier shall not be obliged to deal with claims delivered to the supplier later than one month after the defect was detected. The defective part that has been replaced in connection with repair under this guarantee must be sent to the supplier if not otherwise agreed.
6. The guarantee concerns only new machines which are used by their first owners.
7. The guarantee period for spare parts is three months.